

# ONE BEDROOM TYPE 1

Orientation  
on floorplate

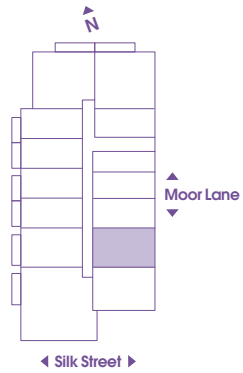

This apartment is  
available on floors 7-30

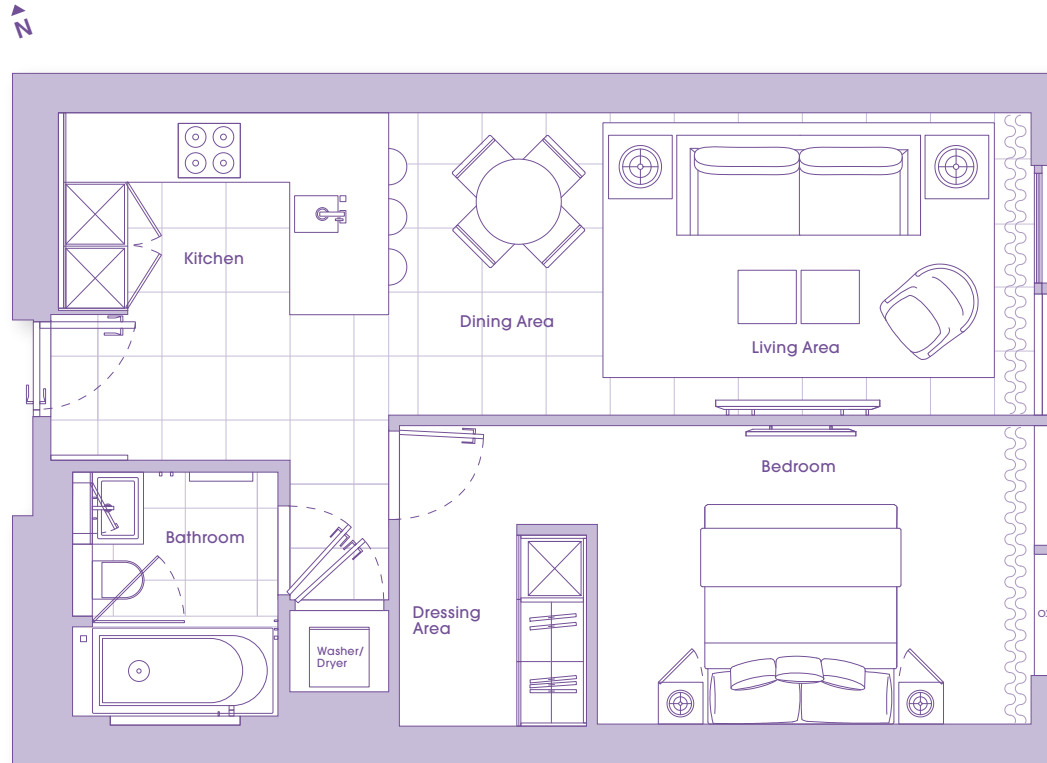
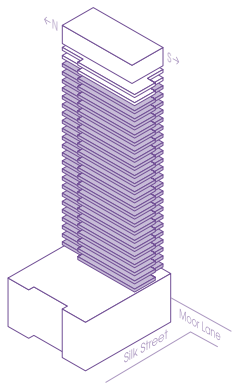

## INTERNAL DIMENSIONS

Gross Internal Area  
52 sq m / 564 sq ft

Living/Dining Area  
6.05m x 2.83m  
19'85" x 9'28"

Kitchen  
3.10m x 1.89m  
10'17" x 6'20"

Bedroom  
5.95m x 2.82m  
19'52" x 9'25"

Arrow indicates  
window opening to  
Juliet balcony.

Wheelchair accessible  
apartments available  
on floors 7-15.

O.V. denotes  
opening vent.

**Note:** All areas and dimensions have been taken from architects plans prior to construction therefore whilst the information is believed to be correct its accuracy cannot be guaranteed and does not form part of any contract. Maximum Gross Internal Areas have been rounded to the nearest sq ft / sq m